

PLW3CD/W3CD CELLULAR ACOUSTICAL DECK GRADE 50 STEEL

LRFD

W3 CELLULAR ACOUSTICAL FORMLOK® COMPOSITE DECK

- PLW3CD-36 AC FormLok Deck used with PunchLok® II System
- W3CD-36 AC FormLok Deck used with TSWs or BPs

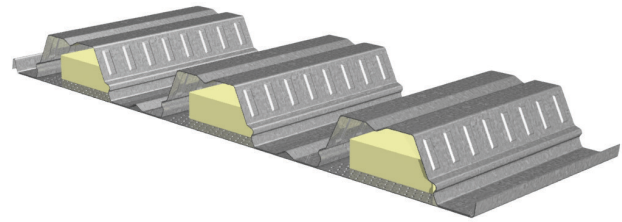

Nominal Dimensions

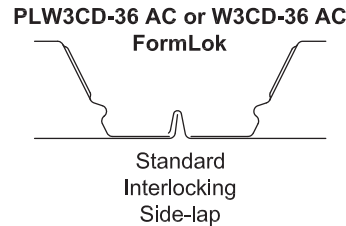
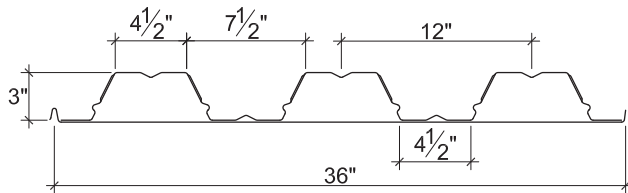

Section Properties

Deck Gage	Deck Weight w_{dd} (psf)	Base Metal Thickness t (in.)	Yield Strength F_y (ksi)	Effective Moment of Inertia at Service Load $I_d = (2I_e + I_g)/3$		Effective Section Modulus at $F_y = 50$ ksi		Vertical Web Shear ϕV_n (lb/ft)	Vertical Shear ϕV_n	
				I_{d+} (in ⁴ /ft)	I_{d-} (in ⁴ /ft)	S_{e+} (in ³ /ft)	S_{e-} (in ³ /ft)		End (lb/ft)	Interior (lb/ft)
20/20	3.6	0.0359/0.0359	50	1.425	1.124	0.542	0.608	3587	896	1871
20/18	4.0	0.0359/0.0478	50	1.528	1.226	0.542	0.640	3587	824	1058
18/20	4.1	0.0478/0.0359	50	1.776	1.425	0.847	0.794	6515	991	2559
18/18	4.6	0.0478/0.0478	50	1.909	1.539	0.863	0.830	6515	1363	2045
18/16	5.0	0.0478/0.0598	50	2.020	1.659	0.860	0.862	6515	1275	1463
16/18	5.2	0.0598/0.0478	50	2.267	1.845	1.099	1.018	9422	1472	2473
16/16	5.7	0.0598/0.0598	50	2.402	1.975	1.116	1.057	9422	1892	2332

Design Reactions at Supports Based on Web Crippling, ϕR_n (lb/ft)

Deck Gage	Bearing Length of Webs											
	One-Flange Loading						Two-Flange Loading					
	End Bearing				Interior Bearing		End Bearing				Interior Bearing	
	1 1/2"	2"	3"	4"	4"	8"	1 1/2"	2"	3"	4"	4"	8"
20/XX	754	827	947	1049	1622	2010	763	819	913	992	1914	2405
18/XX	1293	1410	1606	1771	2744	3436	1435	1532	1696	1834	3315	4218
16/XX	1966	2135	2419	2658	4134	5130	2321	2469	2718	2927	5066	6392

Standard Features

- ASTM A653 SS GR50 Min., with G60
- Standard lengths – 7'-6" to 30'-0"
- IAPMO UES ER-2018 and UL Listed
- Tables conform to ANSI/SDI RD-2017 and C-2017

Optional Features

- Inquire regarding cost and lead times for:
 - Sheet Lengths > 30'-0"
 - Alternative metallic finishes

NOTICE: Design defects that could cause injury or death may result from relying on the information in this document without independent verification by a qualified professional. The information in this document is provided "AS IS". Nucor Corporation and its affiliates expressly disclaim: (i) any and all representations, warranties and conditions and (ii) all liability arising out of or related to this document and the information in it.