

# 2.0D DOVETAIL FORMLOK® DECK-SLAB ACOUSTICAL SOLUTIONS

**ACHIEVE QUIET SPACES WITH PREMIUM FINISHES BY USING THE SUPERIOR STC AND IIC RATINGS OF 2.0D FORMLOK DECK-SLABS**

## 2.0D FORMLOK DECK-SLAB

- 2" Deep Composite Deck
- 5½" Total Slab Depth
- Normal Weight Concrete (145 pcf)
- Exposed Deck Ceiling

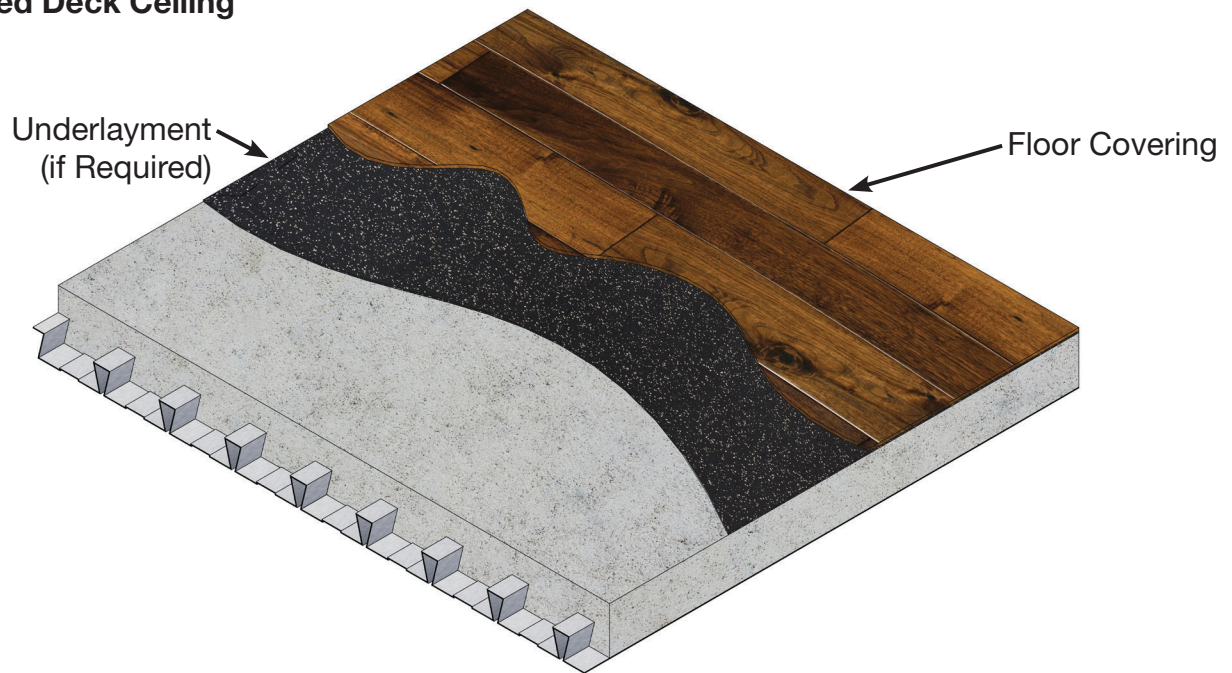

### Exposed Deck (No Ceiling)

Floor Covering	Underlayment	STC	IIC	Intertek Test No.
Ceramic Tile	5 mm ECOsilence	<b>51</b>	<b>41</b>	<a href="#">H7786.06</a>
Engineered Wood	5 mm ECOsilence	<b>50</b>	<b>50</b>	<a href="#">H7786.05</a>
Fusion Hybrid Vinyl Plank	2 mm ECOsilence	<b>46</b>	<b>51</b>	<a href="#">H7786.02</a>
Attain Luxury Vinyl Tile	5 mm ECOsilence	<b>52</b>	<b>51</b>	<a href="#">H7786.03</a>
Forest Rx Rubber Backed Sheet Vinyl	None	<b>51</b>	<b>51</b>	<a href="#">H7786.04</a>
Exposed Concrete	None	<b>52</b>	<b>23</b>	<a href="#">H7786.01</a>

# 2.0D DOVETAIL FORMLOK® DECK-SLAB ACOUSTICAL SOLUTIONS

## 2.0D FORMLOK DECK-SLAB

- 2" Deep Composite Deck
- 5½" Total Slab Depth
- Normal Weight Concrete (145 pcf)
- Gypsum Board Ceiling

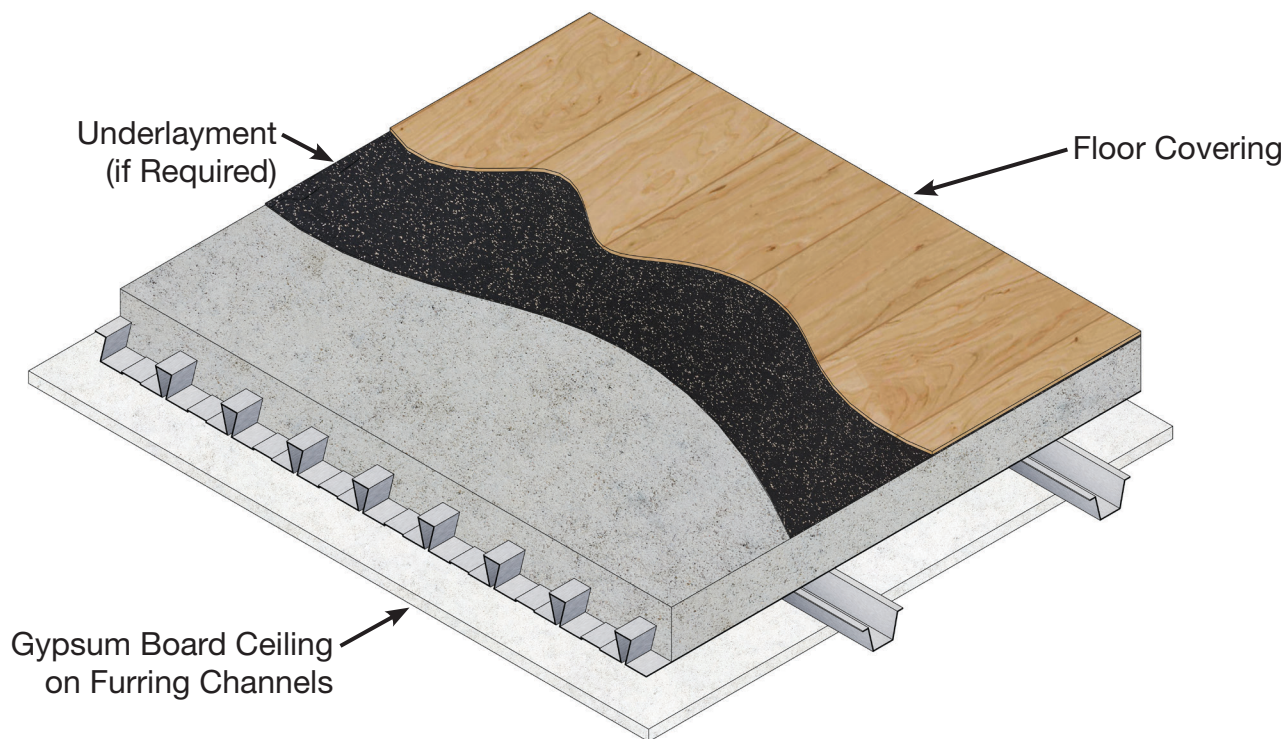

### Gypsum Board Ceiling on Furring Channels Directly Attached to Deck

Floor Covering	Underlayment	STC	IIC	Intertek Test No.
Ceramic Tile	5 mm ECOsilence	<b>53</b>	<b>47</b>	<a href="#">H7786.12</a>
Engineered Wood	5 mm ECOsilence	<b>50</b>	<b>50</b>	<a href="#">H7786.11</a>
Fusion Hybrid Vinyl Plank	2 mm ECOsilence	<b>51</b>	<b>50</b>	<a href="#">H7786.08</a>
Attain Luxury Vinyl Tile	2 mm ECOsilence	<b>52</b>	<b>50</b>	<a href="#">H7786.09</a>
Forest Rx Rubber Backed Sheet Vinyl	None	<b>50</b>	<b>50</b>	<a href="#">H7786.10</a>
Exposed Concrete	None	<b>52</b>	<b>32</b>	<a href="#">H7786.07</a>

#### Note:

1. Values shown are for gypsum board on furring channels directly connected to the underside of the slab. Gypsum board ceilings attached to the deck by methods providing acoustical separation will provide improved STC and IIC values.

# 2.0D DOVETAIL FORMLOK® DECK-SLAB ACOUSTICAL SOLUTIONS

## 2.0D FORMLOK DECK-SLAB

- 2" Deep Composite Deck
- 5½" Total Slab Depth
- Normal Weight Concrete (145 pcf)
- Suspended Gypsum Board Ceiling

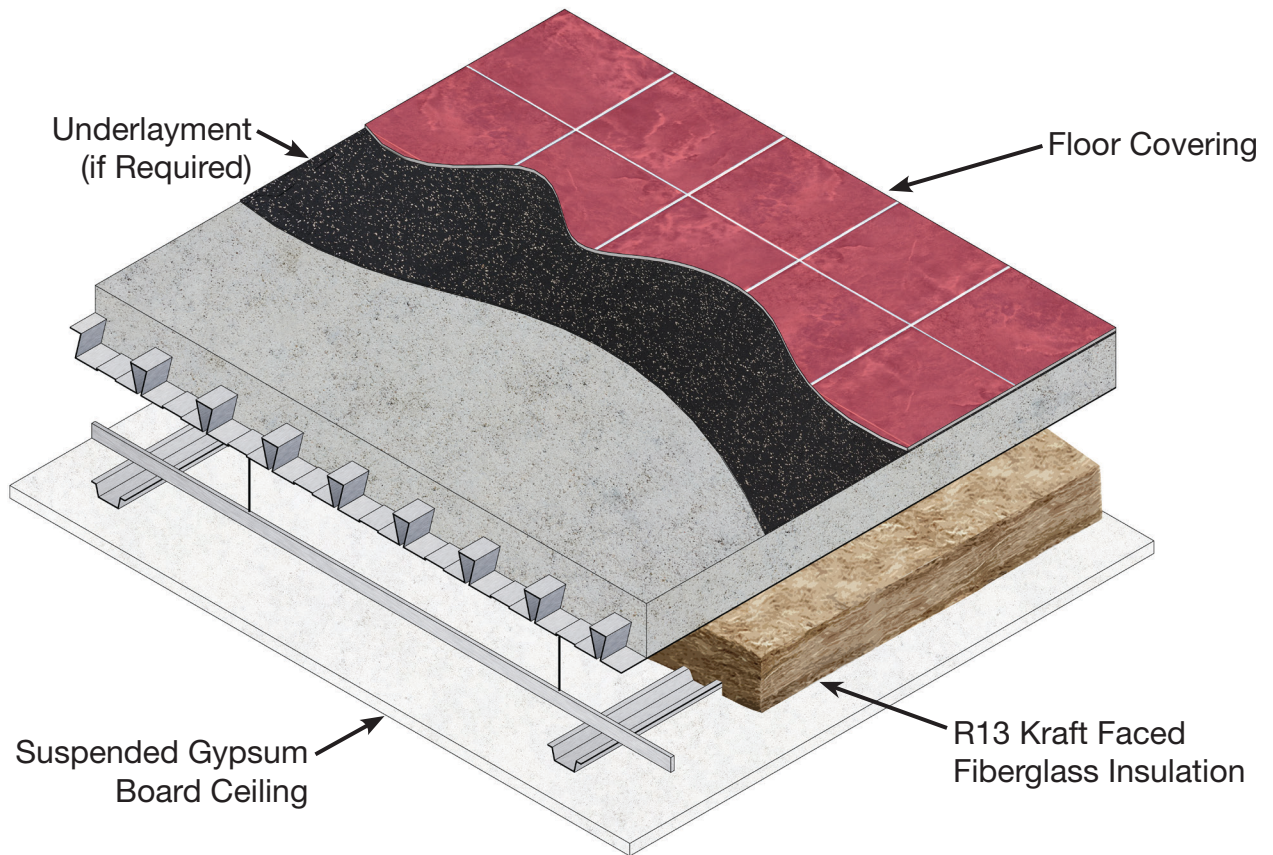

### Suspended Gypsum Board Ceiling

Floor Covering	Underlayment	STC	IIC	Intertek Test No.
Ceramic Tile	5 mm ECOsilence	62	60	<a href="#">I5133.01</a>

#### Note:

1. Laboratory tests determining STC and IIC for DoveTail FormLok deck with a suspended ceiling were conducted with ceramic tile and underlayment. Adding a suspended ceiling to the ceramic tile assembly improved the STC rating by 11 and the IIC rating by 19 compared to an assembly with no ceiling. Other flooring types can expect similar improvement in performance.

## 2.0D DOVETAIL FORMLOK® DECK-SLAB

### Notes:

1. The acoustical test reports with complete assembly details are available from [www.dovetaildeck.com](http://www.dovetaildeck.com).
2. The testing was performed in accordance with the following standards:
  - **ASTM E90-09 (2016)**, *Standard Test Method for Laboratory Measurement of Airborne Sound Transmission Loss of Building Partitions*
  - **ASTM E492-09(2016)e1**, *Standard Test Method for Laboratory Measurement of Impact Sound Transmission Through Floor-Ceiling Assemblies Using the Tapping Machine*

NOTICE: Design defects that could cause injury or death may result from relying on the information in this document without independent verification by a qualified professional. The information in this document is provided "AS IS". Nucor Corporation and its affiliates expressly disclaim: (i) any and all representations, warranties and conditions and (ii) all liability arising out of or related to this document and the information in it.

# 3.5D DOVETAIL FORMLOK® DECK-SLAB ACOUSTICAL SOLUTIONS

**ACHIEVE QUIET SPACES WITH PREMIUM FINISHES BY USING THE SUPERIOR STC AND IIC RATINGS OF 3.5D FORMLOK DECK-SLABS**

## 3.5D FORMLOK DECK-SLAB

- 3½” Deep Composite Deck
- 6” Total Slab Depth
- Normal Weight Concrete (145 pcf)
- Exposed Deck Ceiling

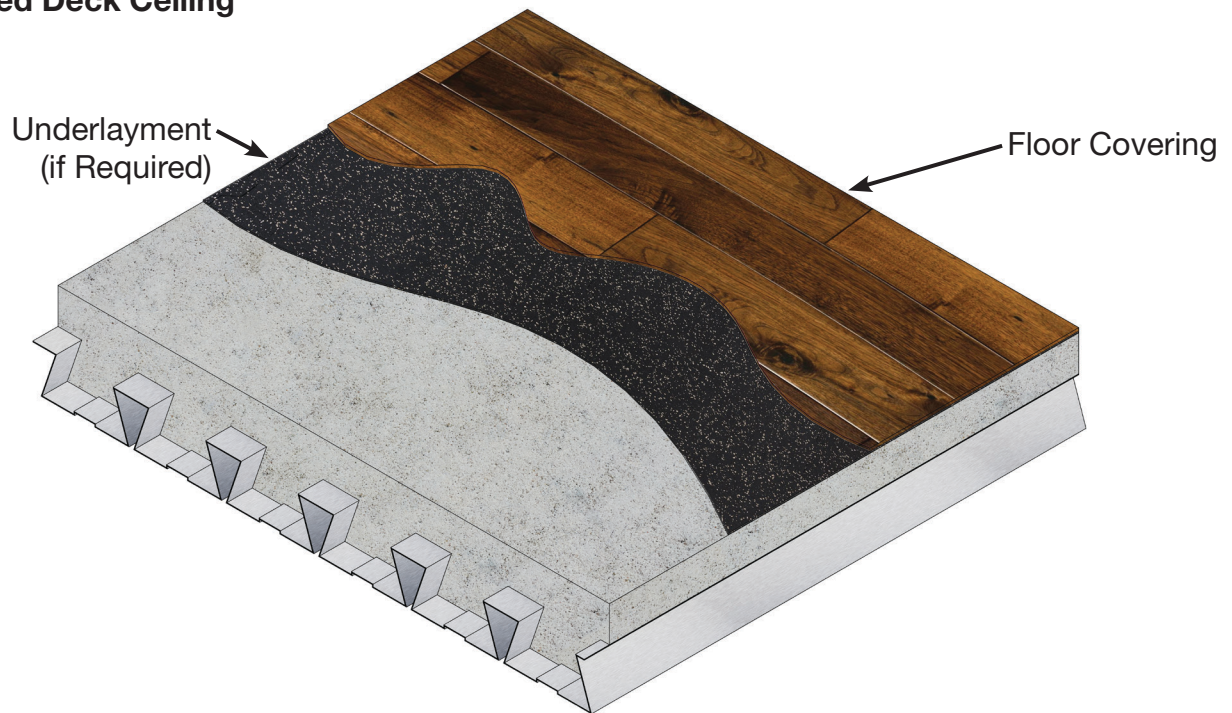

### Exposed Deck (No Ceiling)

Floor Covering	Underlayment	STC	IIC	Intertek Test No.
Ceramic Tile	5 mm ECOsilence	<b>50</b>	<b>42</b>	<a href="#">H7787.06</a>
Engineered Wood	5 mm ECOsilence	<b>45</b>	<b>46</b>	<a href="#">H7787.05</a>
Fusion Hybrid Vinyl Plank	2 mm ECOsilence	<b>47</b>	<b>47</b>	<a href="#">H7787.02</a>
Attain Luxury Vinyl Tile	5 mm ECOsilence	<b>50</b>	<b>50</b>	<a href="#">H7787.03</a>
Forest Rx Rubber Backed Sheet Vinyl	None	<b>49</b>	<b>49</b>	<a href="#">H7787.04</a>
Exposed Concrete	None	<b>50</b>	<b>24</b>	<a href="#">H7787.01</a>

# 3.5D DOVETAIL FORMLOK® DECK-SLAB ACOUSTICAL SOLUTIONS

## 3.5D FORMLOK DECK-SLAB

- 3½” Deep Composite Deck
- 6” Total Slab Depth
- Normal Weight Concrete (145 pcf)
- Gypsum Board Ceiling

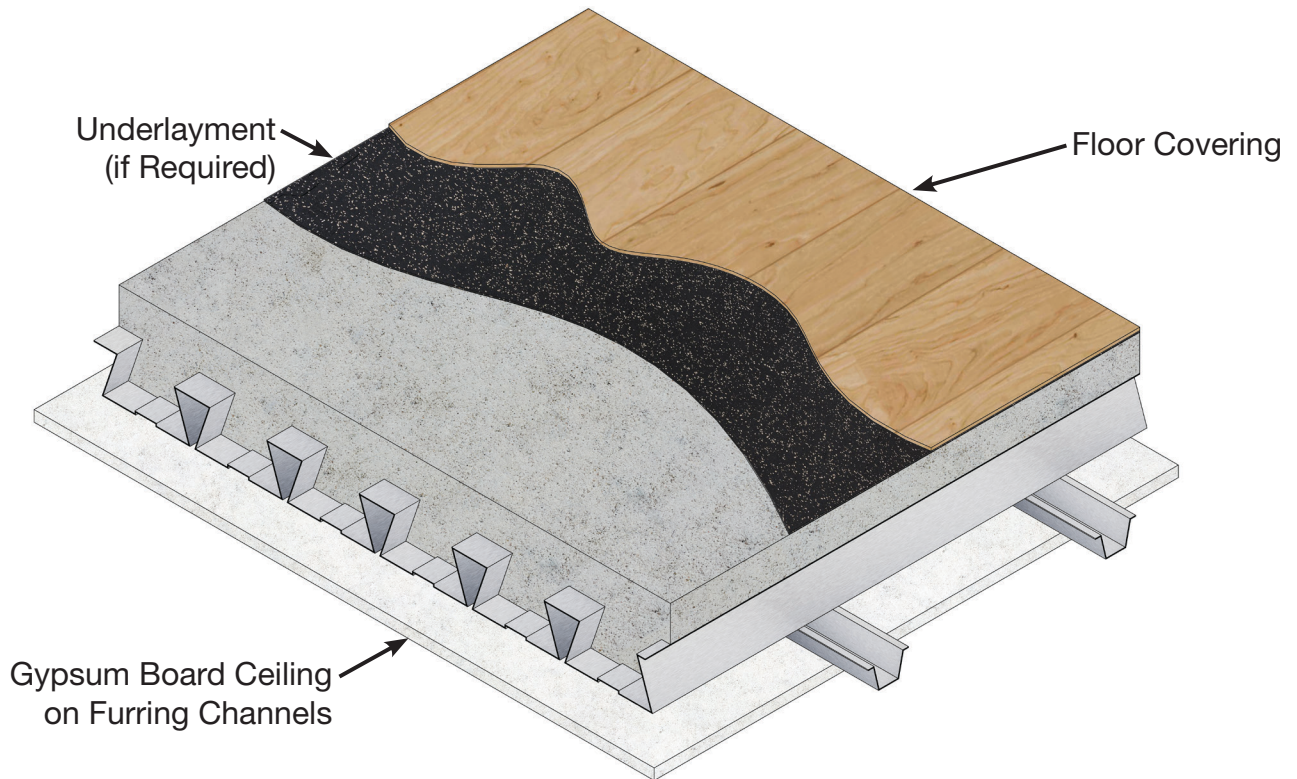

### Gypsum Board Ceiling on Furring Channels Directly Attached to Deck

Floor Covering	Underlayment	STC	IIC	Intertek Test No.
Ceramic Tile	5 mm ECOsilence	<b>56</b>	<b>49</b>	<a href="#">H7787.12</a>
Engineered Wood	5 mm ECOsilence	<b>55</b>	<b>52</b>	<a href="#">H7787.11</a>
Fusion Hybrid Vinyl Plank	2 mm ECOsilence	<b>55</b>	<b>53</b>	<a href="#">H7787.08</a>
Attain Luxury Vinyl Tile	5 mm ECOsilence	<b>56</b>	<b>52</b>	<a href="#">H7787.09</a>
Forest Rx Rubber Backed Sheet Vinyl	None	<b>55</b>	<b>52</b>	<a href="#">H7787.10</a>
Exposed Concrete	None	<b>55</b>	<b>32</b>	<a href="#">H7787.07</a>

#### Note:

1. Values shown are for gypsum board on furring channels directly connected to the underside of the slab. Gypsum board ceilings attached to the deck by methods providing acoustical separation will provide improved STC and IIC values.

# 3.5D DOVETAIL FORMLOK® DECK-SLAB ACOUSTICAL SOLUTIONS

## 3.5D FORMLOK DECK-SLAB

- 3½” Deep Composite Deck
- 6” Total Slab Depth
- Normal Weight Concrete (145 pcf)
- Suspended Gypsum Board Ceiling

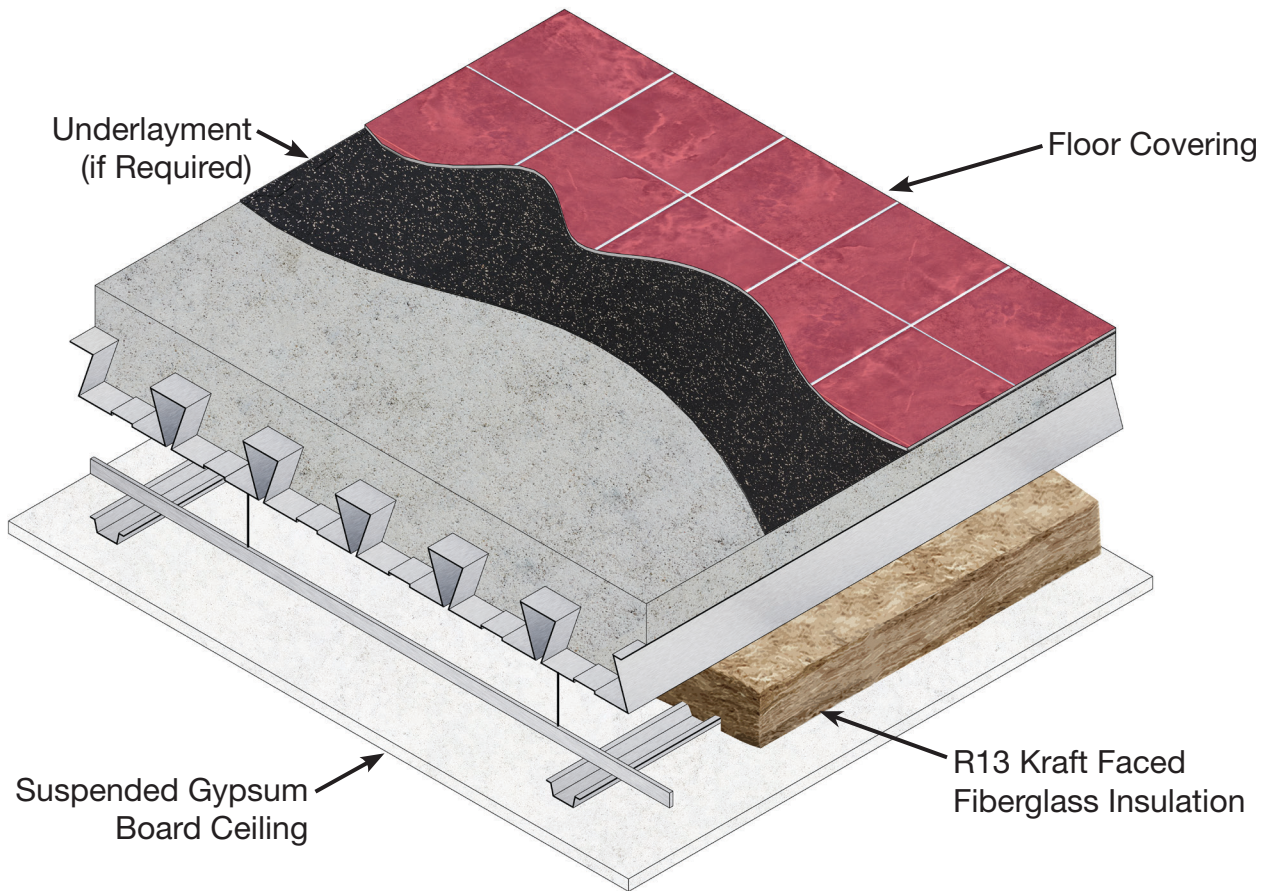

### Suspended Gypsum Board Ceiling

Floor Covering	Underlayment	STC	IIC	Intertek Test No.
Ceramic Tile	5 mm ECOsilence	62	62	<a href="#">I5133.02</a>

#### Note:

1. Laboratory tests determining STC and IIC for DoveTail FormLok deck with a suspended ceiling were conducted with ceramic tile and underlayment. Adding a suspended ceiling to the ceramic tile assembly improved the STC rating by 12 and the IIC rating by 20 compared to an assembly with no ceiling. Other flooring types can expect similar improvement in performance.

## 3.5D DOVETAIL FORMLOK® DECK-SLAB

### Notes:

1. The acoustical test reports with complete assembly details are available from [www.dovetaildeck.com](http://www.dovetaildeck.com).
2. The testing was performed in accordance with the following standards:
  - **ASTM E90-09 (2016)**, *Standard Test Method for Laboratory Measurement of Airborne Sound Transmission Loss of Building Partitions*
  - **ASTM E492-09(2016)e1**, *Standard Test Method for Laboratory Measurement of Impact Sound Transmission Through Floor-Ceiling Assemblies Using the Tapping Machine*

NOTICE: Design defects that could cause injury or death may result from relying on the information in this document without independent verification by a qualified professional. The information in this document is provided "AS IS". Nucor Corporation and its affiliates expressly disclaim: (i) any and all representations, warranties and conditions and (ii) all liability arising out of or related to this document and the information in it.